

# DUST REDUCTION KIT

## DCR 100 & 300

114 11 90-26  
Rev.B

Point the mobile camera at the QR code  
to show the assembly instruction video



Assembly instruction  
DCR 100

<https://youtu.be/7vI0WJX42P0>



Assembly instruction  
DCR 300

<https://youtu.be/gaoHzAvySE0>

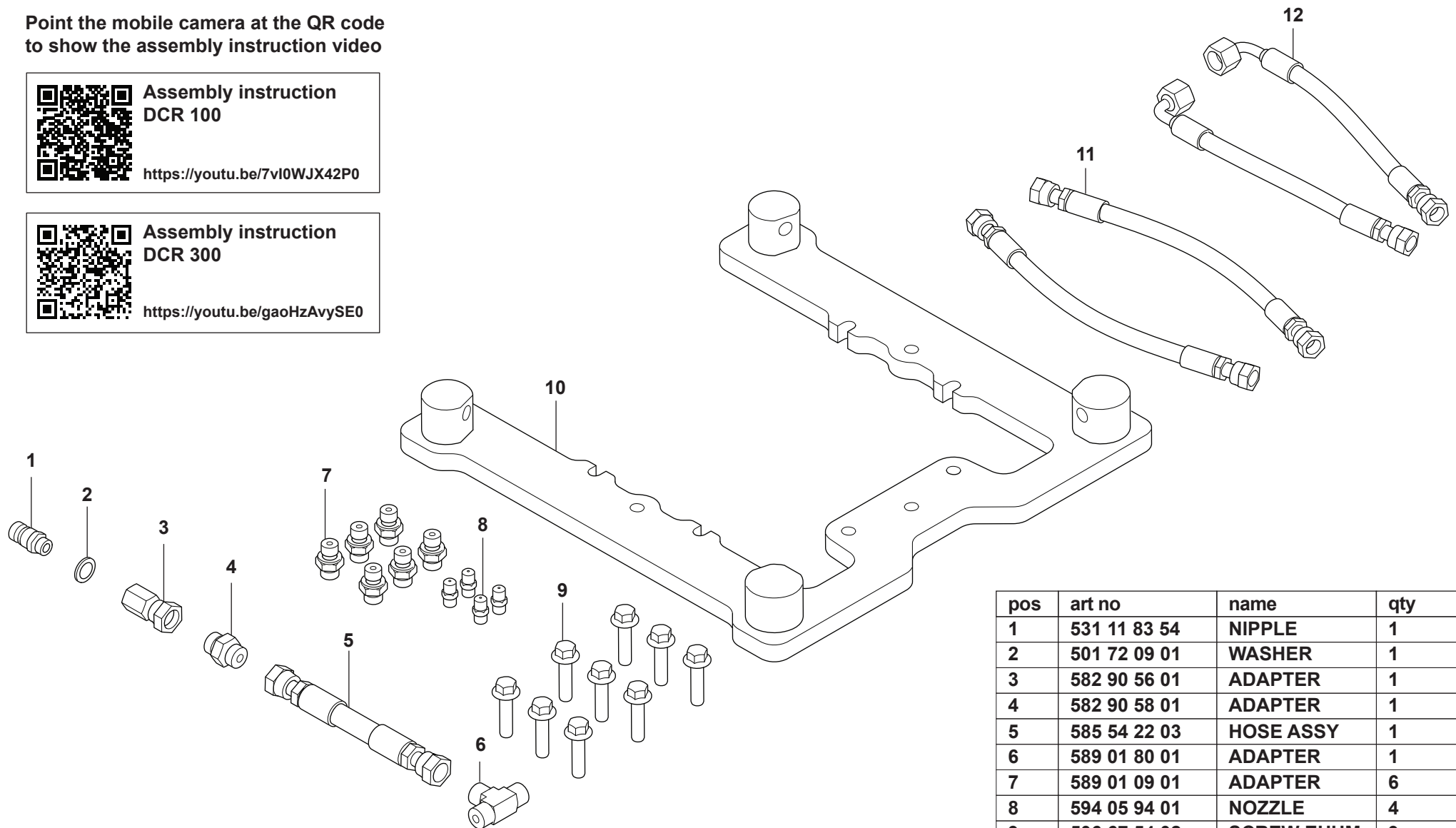

pos	art no	name	qty
1	531 11 83 54	NIPPLE	1
2	501 72 09 01	WASHER	1
3	582 90 56 01	ADAPTER	1
4	582 90 58 01	ADAPTER	1
5	585 54 22 03	HOSE ASSY	1
6	589 01 80 01	ADAPTER	1
7	589 01 09 01	ADAPTER	6
8	594 05 94 01	NOZZLE	4
9	506 67 54 02	SCREW EHHM	9
10	593 36 00 01	BRACKET	1
11	585 48 42 15	HOSE ASSY	2
12	582 31 37 03	HOSE ASSY	2